



FRONT ELEVATION



REAR ELEVATION

OVERVIEW

TOTAL: 2371+ Sq. Ft.

BEDROOMS: 3+

BATHROOMS: 2.5+

- 9' Ceiling Heights Throughout with 11' Ceilings In Spacious Great Room
- Cozy Great Room with Built-In Bookcase and Striking Fireplace is Open to Adjoining Breakfast Area and Kitchen
- Split 3 Bedroom Plan
- Optional Bedrooms or Playroom on Ground Floor
- Comfortable First Floor Master Suite Flaunts Large Bath with 2 Walk-In Closets, Dual Sink Vanity, and Relaxing Whirlpool tub
- 3 Bay Side Entry Garage

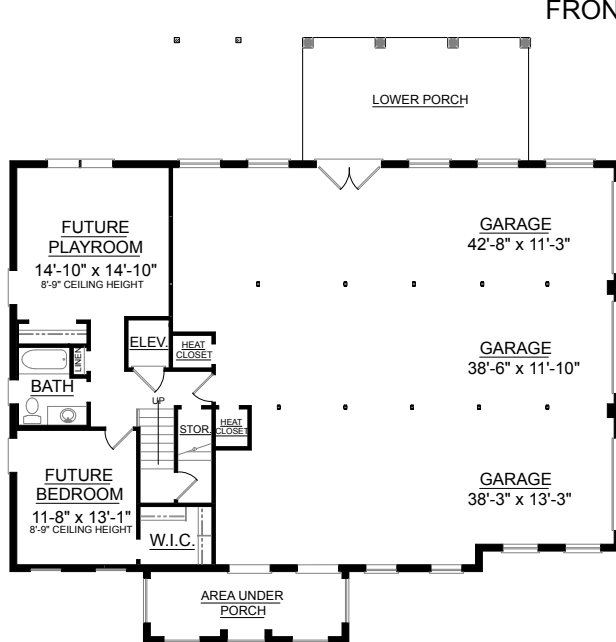

GROUND FLOOR PLAN

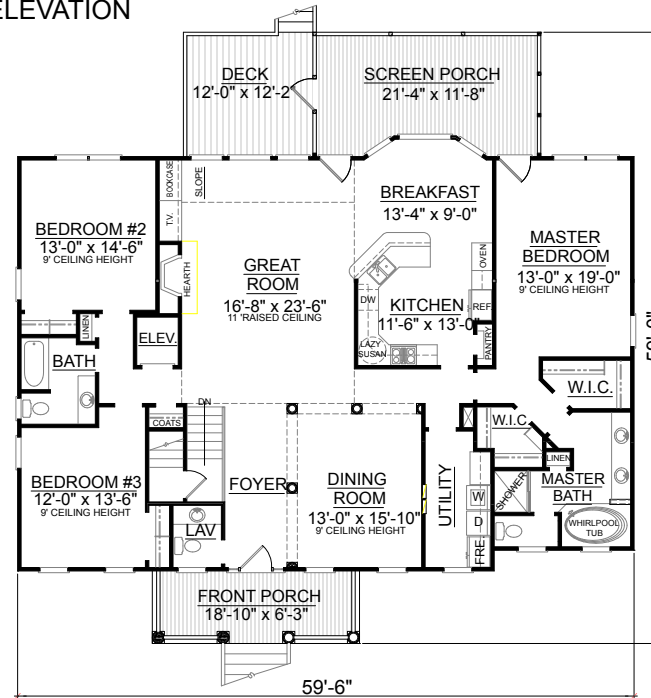

FIRST FLOOR PLAN
Plan No.

2371-746-B

First Floor	2371 Sq. Ft.
Finished Ground Floor	746 Sq. Ft.
Garage	1607 Sq. Ft.
Deck	150 Sq. Ft.
Screen Porch	246 Sq. Ft.
Front Porch	140 Sq. Ft.
Overall Height	31'-2"